

# EX - PLUG AND RECEPTACLE

**16 A to 125 A  
plugs and receptacles plastic version for Zone 2**

## 1 A good connection

Providing electrical energy there, where it is most needed – even in hazardous areas for Zone 2.

Non-stationary electrical apparatus have generally high requirements on the energy/power supply. Robust plugs and receptacles as well as a high chemical resistance are at the first glance very important. Electrical reliability is a must not only for all connectivity products.

A high safety standard, a steady hold and faultless contacting even under vibration or the effects of an aggressive atmospheric environment are the basis for a secure and reliable utilisation

CEAG plugs and receptacles offer more, apart from the proven technology, this product series is defined by its innovative details. For example, the very efficient cable strain relief or the new coding system of the various versions offers different solutions for a secure and problem free utilization in all areas. Just to round the product off, the user in the normal industrial sector becomes exactly the same product advantages. Robust industrial versions fulfil all requirements appertaining to mechanical and chemical durability. For the stationary repair power supplying in hazardous explosive areas, there is a specially conceived version available that fulfils all the necessary safety requirements. Used in a module sense, individual solutions are no problem at all.

The CEAG wall socket for instance can be mounted on to the pre-installed mounting frame without having to use tools – installation without a hot work permit.

Apart from the plugs and receptacles for the European market, we also have plugs and sockets extra for the US market, which are in accordance to all of the necessary standards UL and safety protection systems used there. The available standard range used here, are the 20 A, 30 A, 60 A and 100 A.

### International approvals.

- **Safety standard IP66 applies also in the plugged-in state**
- **Full AC-3 switching ability**
- **Self-cleaning lamellar contacts, low transition resistance**
- **All-pole on/off switching**
- **Easy plugging**



# 1.6

## Ex-Plugs and Receptacles Plastic Version for Zone 2

1 16 A to 125 A

### A good connection

Providing electrical energy there, where it is most needed – even in hazardous areas for Zone 2.

Non-stationary electrical apparatus have generally high requirements on the energy/power supply. Robust plugs and receptacles as well as a high chemical resistance are at the first glance very important. Electrical reliability is a must not only for all connectivity products.

A high safety standard, a steady hold and faultless contacting

even under vibration or the effects of an aggressive atmospheric environment are the basis for a secure and reliable utilisation

CEAG plugs and receptacles offer more, apart from the proven technology, this product series is defined by its innovative details. For example, the very efficient cable strain relief or the new coding system of the various versions offers different solutions for a secure and problem free utilization in all areas. Just to round the product off,

the user in the normal industrial sector becomes exactly the same product advantages. Robust industrial versions fulfil all requirements pertaining to mechanical and chemical durability.

For the stationary repair power supplying in hazardous explosive areas, there is a specially conceived version available that fulfils all the necessary safety requirements. Used in a module sense, individual solutions are no problem at all.

The CEAG wall socket for instance can be mounted on to the pre-installed mounting frame without having to use tools – installation without a hot work permit.

Apart from the plugs and receptacles for the European market, we also have plugs and sockets extra for the US market, which are in accordance to all of the necessary standards UL and safety protection systems used there. The available standard range used here, are the 20 A, 30 A, 60 A and 100 A.



### Features

- **Safety standard IP66 applies also in the plugged-in state**
- **Full AC-3 switching ability**
- **Self-cleaning lamellar contacts, low transition resistance**
- **All-pole on/off switching**
- **Easy plugging**

## Ex-plugs and receptacles zone 2: 16 A 3/4/5-pole up to 690 V



Plug



Coupler



Flange socket



Wall socket

### Technical data

#### Ex-plugs and receptacles acc. to IEC 60309-1/2 16A

Marking accd. to 2014/34/EU	⊕ II 3 G Ex nC IIC T5/T6
EC-Type Examination Certificate	PTB 99 ATEX 1115
Permissible ambient temperature	-20°C up to +40°C <sup>1)</sup>
Rated voltage	up to 400 V (3-pole) / 750 V (4-pole) / 500 V (5-pole) AC
Rated current	up to 16 A
Frequency	up to 400 Hz
Rated making / Rated breaking capacity AC-3 accd. EN 60947-3	400 V / 16 A
External back-up fuse, max.	without therm. protection: 16 A with therm. protection: 35 A gG (rated current 16 A set to)
Protection class	I
Degree of protection accd. to EN 60529	IP66

#### Wall socket

Cable entry	1 x M25 cable gland, 1 x M25 plastic Ex-screw plug or 2 x metal thread M20 with plastic Ex-screw plug
Connecting terminals	2 x 1.5 - 4 mm <sup>2</sup>
Enclosure material	glass-fibre reinforced polyester

#### Plug

Cable entry	Ø 8 - 19 mm (3-pole) / Ø 8 - 21 mm (4-pole) / 12 - 21 mm (5-pole)
Connecting terminals	1 x 1.0 - 2.5 mm <sup>2</sup>
Enclosure material	Polyamide

#### Coupler

Cable entry	Ø 8 - 19 mm (3-pole) / Ø 8 - 21 mm (4-pole) / 12 - 21 mm (5-pole)
Connecting terminals	2 x 1.5 - 4 mm <sup>2</sup>
Enclosure material	Polyamide

#### Flange socket

Connecting terminals	2 x 1 - 4 mm <sup>2</sup>
Enclosure material	Polyamide

<sup>1)</sup> extended temperature range on request

Details for used cable glands see pages 2.3.ff

## Ex-plugs and receptacles zone 2: 16A 3/4/5-pole up to 690 V



Wall socket



Flange socket









Coupler

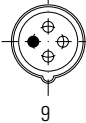

Plug

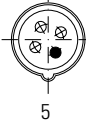
### Ordering details

Voltage	h	Type	Cable entry	Weight approx.	Order No.
<b>Type 16 A 3-pole</b>					
110-130 V		Wall socket	KU	1.2 kg	<b>GHG 516 4304 R0001</b>
		Wall socket	ME	1.3 kg	<b>GHG 516 4304 R3001</b>
		Flange socket		0.35 kg	<b>GHG 516 8304 R0001</b>
		Coupler		0.7 kg	<b>GHG 516 3304 R0001</b>
		Plug		0.35 kg	<b>GHG 516 7304 R0001</b>
200-250 V		Wall socket	KU	1.2 kg	<b>GHG 516 4306 R0001</b>
		Wall socket	ME	1.3 kg	<b>GHG 516 4306 R3001</b>
		Flange socket		0.4 kg	<b>GHG 516 8306 R0001</b>
		Coupler		0.7 kg	<b>GHG 516 3306 R0001</b>
		Plug		0.35 kg	<b>GHG 516 7306 R0001</b>
<b>Type 16 A 4-pole</b>					
200-250 V		Wall socket	KU	1.4 kg	<b>GHG 516 4409 R0001</b>
		Wall socket	ME	1.5 kg	<b>GHG 516 4409 R3001</b>
		Flange socket		3.8 kg	<b>GHG 516 8409 R0001</b>
		Coupler		0.9 kg	<b>GHG 516 3409 R0001</b>
		Plug		0.38 kg	<b>GHG 516 7409 R0001</b>
380-415 V		Wall socket	KU	1.4 kg	<b>GHG 516 4406 R0001</b>
		Wall socket	ME	1.5 kg	<b>GHG 516 4406 R3001</b>
		Flange socket		3.8 kg	<b>GHG 516 8406 R0001</b>
		Coupler		0.9 kg	<b>GHG 516 3406 R0001</b>
		Plug		0.38 kg	<b>GHG 516 7406 R0001</b>
480-500 V		Wall socket	KU	1.4 kg	<b>GHG 516 4407 R0001</b>
		Wall socket	ME	1.5 kg	<b>GHG 516 4407 R3001</b>
		Flange socket		3.8 kg	<b>GHG 516 8407 R0001</b>
		Coupler		0.9 kg	<b>GHG 516 3407 R0001</b>
		Plug		0.38 kg	<b>GHG 516 7407 R0001</b>
600-690 V		Wall socket	KU	1.8 kg	<b>GHG 516 4405 R0001</b>
		Wall socket	ME	1.9 kg	<b>GHG 516 4405 R3001</b>
		Flange socket		3.8 kg	<b>GHG 516 8405 R0001</b>
		Coupler		0.9 kg	<b>GHG 516 3405 R0001</b>
		Plug		0.38 kg	<b>GHG 516 7405 R0001</b>
<b>Type 16 A 5-pole</b>					
200-250 V 380-415 V		Wall socket	KU	1.4 kg	<b>GHG 516 4506 R0001</b>
		Wall socket	ME	1.5 kg	<b>GHG 516 4506 R3001</b>
		Flange socket		0.4 kg	<b>GHG 516 8506 R0001</b>
		Coupler		0.95 kg	<b>GHG 516 3506 R0001</b>
		Plug		0.42 kg	<b>GHG 516 7506 R0001</b>

other voltage ranges and versions, e.g. with aux. contact, on request

KU = 1 x plastic cable glands M25 cable gland, 1 x M25 plastic Ex-screw plug

ME = 2 x metal thread M20 with plastic Ex-screw plug



Plug



Coupler



Flange socket



Wall socket

Dimension drawing | Wiring diagram

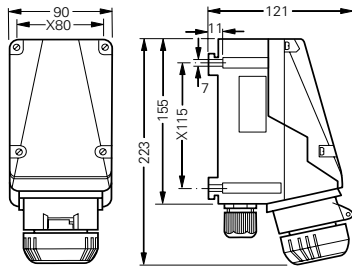

Wall socket 3-pole

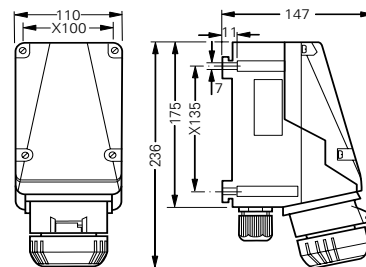

Wall socket 4/5-pole

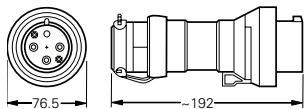

Plug 3-pole

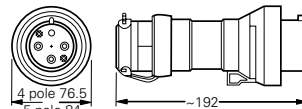

Plug 4/5-pole

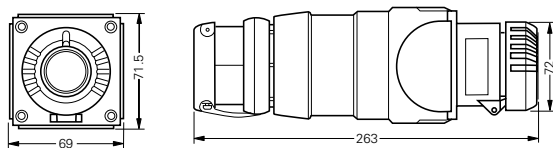

Coupler 3-pole

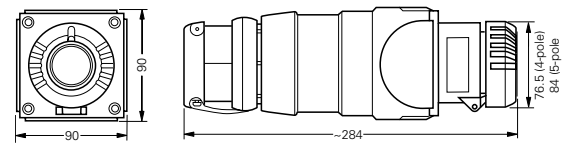

Coupler 4/5-pole

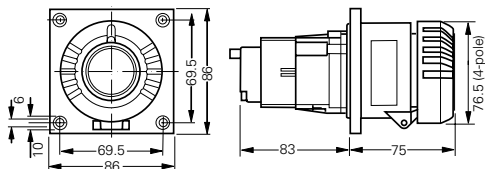

Flange socket 3-pole

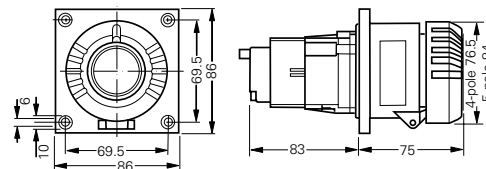

Flange socket 4/5-pole

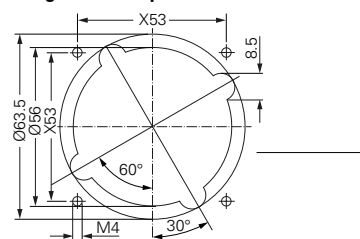

Assembly dimensions flange socket

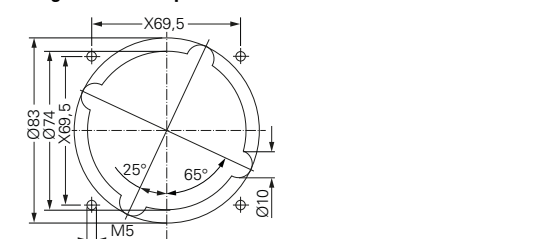

Assembly dimensions flange socket X = fixing dimensions

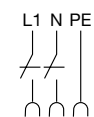

1P + N + PE

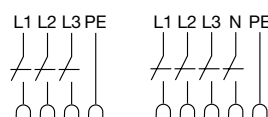

3P + PE

3P + N + PE

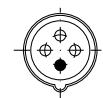

## Accessories for Ex-plugs and receptacles 16 A zone 2



Mounting plate



Plug cap



Protective canopy

### Accessories

Type	Application	Fixing method	Order No.
<b>Mounting plates for wall sockets 16 A</b>			
Size 4	for wall mounting	snap on	<b>GHG 610 1953 R0126</b>
Size 4	for trellis mounting	snap on	<b>GHG 610 1953 R0126</b>
Size 4	for pipe clamp	snap on	<b>GHG 610 1953 R0130</b>

Type	Order No.
<b>Plug cap for plugs 16 A</b>	
Plug 16 A 3-pole	<b>GHG 510 1901 R0001</b>
Plug 16 A 4-pole	<b>GHG 510 1901 R0002</b>
Plug 16 A 5-pole	<b>GHG 510 1901 R0003</b>

Type	OU	Order No.
<b>Accessories for mounting plates</b>		
Mounting set for pipes 1" (Ø 27 - 30 mm) for mounting plates with pipe fixing	10	<b>GHG 610 1953 R0020</b>

Please pay attention that only order units (OU) according to the ordering details can be delivered.

Type	Application	Order No.
<b>Protective canopy for mounting plate</b>		
Size 4	for mounting plate size 4, snap on	<b>GHG 610 1955 R0107</b>

### Dimension drawing

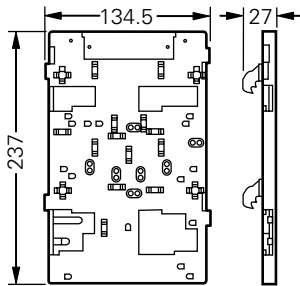

Mounting plate size 4  
for wall/trellis mounting

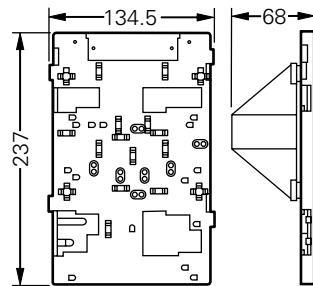

Mounting plate size 4  
for pipe mounting

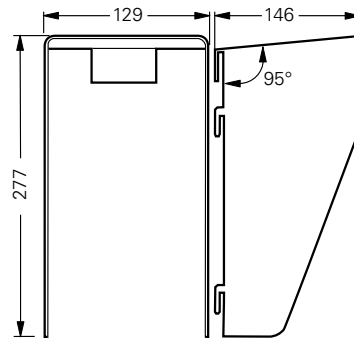

Protective canopy size 4



Plug



Coupler



Flange socket



Wall socket

Technical data

Ex-plugs and receptacles acc. to IEC 60309-1/2

Marking accd. to 2014/34/EU	⊕ II 3 G Ex nC IIC T6
EC-Type Examination Certificate	PTB 99 ATEX 1115
Permissible ambient temperature	-20 °C to +40 °C <sup>1)</sup>
Rated voltage	690 V (AC)
Rated current	up to 32 A
Frequency	up to 400 Hz
Rated making / Rated breaking capacity AC-3 accd. EN 60947-3	$U_e$ 690 V / $I_e$ 32 A
External back up fuse	without therm. protection: 35 A with therm. protection: 50 A gG (rated current 32 A set to)
Protection class	I
Degree of protection accd. to EN 60529	IP66
Enclosure colour	black

Wall socket

Cable entry/enclosure drilling	1 x M40 cable gland, 1 x M40 plastic Ex-screw plug or 2 x M32 metal thread with 2 plastic Ex-screw plug
Connecting terminals	2 x 4 - 10 mm <sup>2</sup>
Enclosure material	glass-fibre reinforced polyester

Plug

Cable entry	Ø 12 - 28 mm
Connecting terminals	1 x 1.0 - 6 mm <sup>2</sup>
Enclosure material	Polyamide

Coupler

Cable entry	Ø 12 - 28 mm
Connecting terminals	2 x 4 - 10 mm <sup>2</sup>
Enclosure material	Polyamide

Flange socket

Connecting terminals	2 x 4 - 10 mm <sup>2</sup>
Enclosure material	Polyamide

<sup>1)</sup> extended temperature range on request

Details for used cable glands see pages 2.3.ff

## Ex-plugs and receptacles zone 2: 32 A 3/4/5-pole up to 690 V



Wall socket



Flange socket



Coupler



Plug

### Ordering details

Voltage	h	Type	Cable entry	Weight approx.	Order No.
<b>Type 32 A 4-pole</b>					
200-250 V		Wall socket	KU	1.8 kg	<b>GHG 517 4409 R0001</b>
		Wall socket	ME	1.9 kg	<b>GHG 517 4409 R3001</b>
		Flange socket		1.0 kg	<b>GHG 517 8409 R0001</b>
		Coupler		1.7 kg	<b>GHG 517 3409 R0001</b>
		Plug		0.7 kg	<b>GHG 517 7409 R0001</b>
380-415 V		Wall socket	KU	1.8 kg	<b>GHG 517 4406 R0001</b>
		Wall socket	ME	1.9 kg	<b>GHG 517 4406 R3001</b>
		Flange socket		1.0 kg	<b>GHG 517 8406 R0001</b>
		Coupler		1.7 kg	<b>GHG 517 3406 R0001</b>
		Plug		0.7 kg	<b>GHG 517 7406 R0001</b>
480-500 V		Wall socket	KU	1.8 kg	<b>GHG 517 4407 R0001</b>
		Wall socket	ME	1.9 kg	<b>GHG 517 4407 R3001</b>
		Flange socket		1.0 kg	<b>GHG 517 8407 R0001</b>
		Coupler		1.7 kg	<b>GHG 517 3407 R0001</b>
		Plug		0.7 kg	<b>GHG 517 7407 R0001</b>
600-690 V		Wall socket	KU	1.8 kg	<b>GHG 517 4405 R0001</b>
		Wall socket	ME	1.9 kg	<b>GHG 517 4405 R3001</b>
		Flange socket		1.0 kg	<b>GHG 517 8405 R0001</b>
		Coupler		1.7 kg	<b>GHG 517 3405 R0001</b>
		Plug		0.7 kg	<b>GHG 517 7405 R0001</b>
<b>Type 32 A 5-pole</b>					
200-250 V 380-415 V		Wall socket	KU	1.8 kg	<b>GHG 517 4506 R0001</b>
		Wall socket	ME	1.9 kg	<b>GHG 517 4506 R3001</b>
		Flange socket		1.0 kg	<b>GHG 517 8506 R0001</b>
		Coupler		1.7 kg	<b>GHG 517 3506 R0001</b>
		Plug		0.7 kg	<b>GHG 517 7506 R0001</b>

other voltage ranges and versions, e.g. with aux. contact, on request

KU = 1 x plastic cable glands M40 cable gland, 1 x M40 plastic Ex-screw plug

ME = 2 x metal thread M32 with plastic Ex-screw plug





Plug



Coupler



Flange socket



Wall socket

Dimension drawing | Wiring diagram

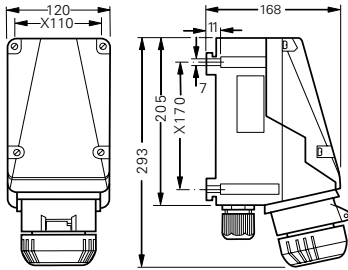

Wall socket 4-pole

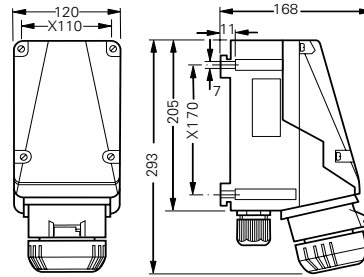

Wall socket 5-pole

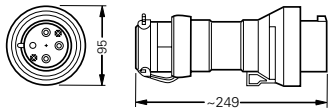

Plug 4-pole

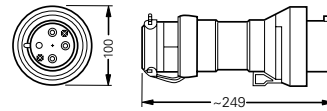

Plug 5-pole

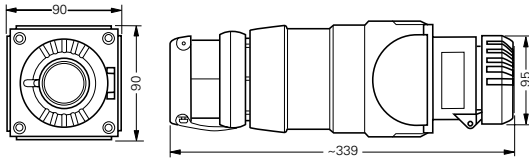

Coupler 4-pole

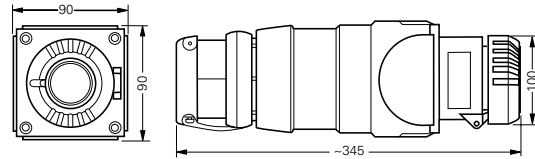

Coupler 5-pole

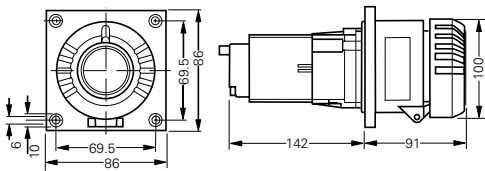

Flange socket 4-pole

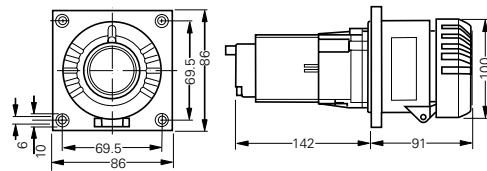

Flange socket 5-pole

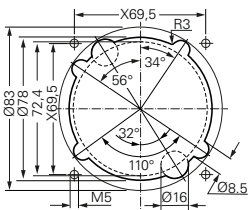

Assembly dimensions flange socket

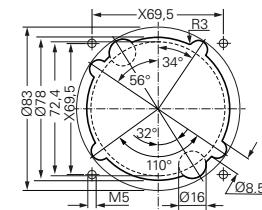

Assembly dimensions flange socket X = fixing dimensions

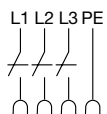

3P + PE

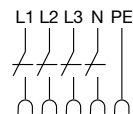
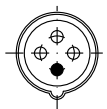

3P + N + PE

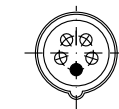

## Accessories for Ex-plugs and receptacles 32 A zone 2



Mounting plate



Plug cap



Protective canopy

### Accessories

Type	Application	Fixing method	Order No.
<b>Mounting plates for wall sockets 32 A</b>			
Size 5	for wall mounting	snap on	<b>GHG 610 1953 R0128</b>
Size 5	for trellis mounting	snap on	<b>GHG 610 1953 R0128</b>
Size 5	for pipe clamp	snap on	<b>GHG 610 1953 R0132</b>
<b>Plug cap for plugs 32 A</b>			
Plug 32 A 3-pole/4-pole			<b>GHG 510 1901 R0004</b>
Plug 32 A 5-pole			<b>GHG 510 1901 R0005</b>
<b>Accessories for mounting plates</b>			
Mounting set for pipes 1" (Ø 27 - 30 mm) for mounting plates with pipe fixing		10	<b>GHG 610 1953 R0020</b>
Please pay attention that only order units (OU) according to the ordering details can be delivered.			
<b>Protective canopy for mounting plate</b>			
Size 5	for mounting plate size 5, snap on		<b>GHG 610 1955 R0108</b>

### Dimension drawing

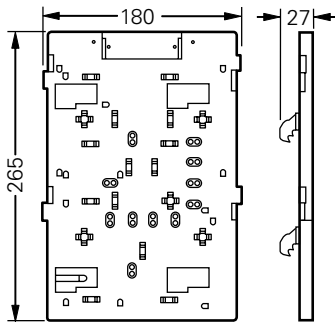

Mounting plate size 5  
for wall/trellis mounting

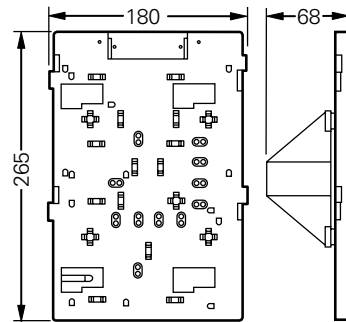

Mounting plate size 5  
for pipe mounting

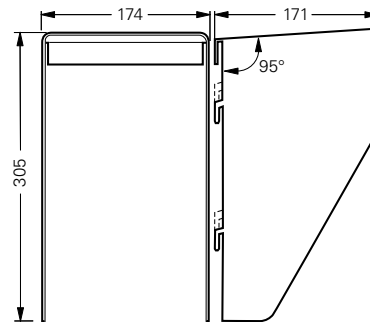

Protective canopy size 5



Plug



Wall socket

1

**Technical data**

**Ex-plugs and receptacles acc. to IEC 60309-1/2 up to 690 V**

Marking accd. to 2014/34/EU	⊕ II 3 G Ex nC IIC T6
EC-Type Examination Certificate	PTB 99 ATEX 1115
Permissible ambient temperature	-20 °C to + 40 °C <sup>1)</sup>
Rated voltage	690 V
Rated current	63 A
Frequency	up to 400 Hz
Rated making / Rated breaking capacity AC-3 accd. EN 60947-3	$U_e$ 690 V / $I_e$ 63 A
External back up fuse	without therm. protection: 63 A with therm. protection: 80 A gG (rated current 63 A set to)
Protection class	I
Degree of protection accd. to EN 60529	IP66
Enclosure colour	black

**Wall socket**

Cable entry/enclosure drilling	1 x M50 cable gland, 1 x M50 plastic Ex-screw plug or 2 x M40 metal thread with plastic Ex-screw plug
Connecting terminals	2 x 4 - 25 mm <sup>2</sup> / with cable lug <sup>2)</sup> 1 x 35 mm <sup>2</sup>
Enclosure material	glass-fibre reinforced polyester

**Plug**

Cable gland	Ø 19 - 34 mm
Connecting terminals	1 x 4 - 16 mm <sup>2</sup> / 1 x 25 mm <sup>2</sup> with pin cable lug
Enclosure material	Polyamide

<sup>1)</sup> extended temperature range on request

<sup>2)</sup> use supplied cable lugs

<sup>3)</sup> see accessories

Details for used cable glands see pages 2.3.ff

## Ex-plugs and receptacles zone 2: 63 A 4/5-pole up to 690 V

1



Wall socket





Plug

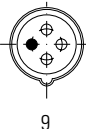

Plug cap

### Ordering details

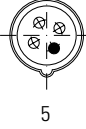
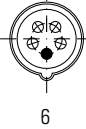
Voltage	h	Type	Cable entry	Weight approx.	Order No.
<b>Type 63 A 4-pole</b>					
200-250 V		Wall socket	KU	8.1 kg	<b>GHG 518 4409 R0001</b>
		Wall socket	ME	8.2 kg	<b>GHG 518 4409 R3001</b>
		Plug		0.75 kg	<b>GHG 518 7409 R0001</b>
380-415 V		Wall socket	KU	8.1 kg	<b>GHG 518 4406 R0001</b>
		Wall socket	ME	8.2 kg	<b>GHG 518 4406 R3001</b>
		Plug		0.75 kg	<b>GHG 518 7406 R0001</b>
480-500 V		Wall socket	KU	8.1 kg	<b>GHG 518 4407 R0001</b>
		Wall socket	ME	8.2 kg	<b>GHG 518 4407 R3001</b>
		Plug		0.75 kg	<b>GHG 518 7407 R0001</b>
600-690 V		Wall socket	KU	8.1 kg	<b>GHG 518 4405 R0001</b>
		Wall socket	ME	8.2 kg	<b>GHG 518 4405 R3001</b>
		Plug		0.75 kg	<b>GHG 518 7405 R0001</b>
<b>Type 63 A 5-pole</b>					
200-250 V 380-415 V		Wall socket	KU	8.15 kg	<b>GHG 518 4506 R0001</b>
		Wall socket	ME	8.25 kg	<b>GHG 518 4506 R3001</b>
		Plug		0.75 kg	<b>GHG 518 7506 R0001</b>

### Accessories

Type	OU	Order No.
<b>Plug cap for plugs</b>		
Set of ring cable lug 35/70 mm <sup>2</sup> for wall socket (6 + 2 pcs.)	1	<b>GHG 510 1916 R0001</b>
Plug cap 4-pole/5-pole	1	<b>GHG 510 1901 R0006</b>
Set of cable lugs 35 mm <sup>2</sup> (5 pcs., for plug)	5	<b>GHG 510 1916 R0001</b>

other voltage ranges and versions, e.g. with aux. contact, on request

KU = 1 x plastic cable glands M40 cable gland, 1 x M40 plastic Ex-screw plug

ME = 2 x metal thread M32 with plastic Ex-screw plug



1

Dimension drawing | Wiring diagram

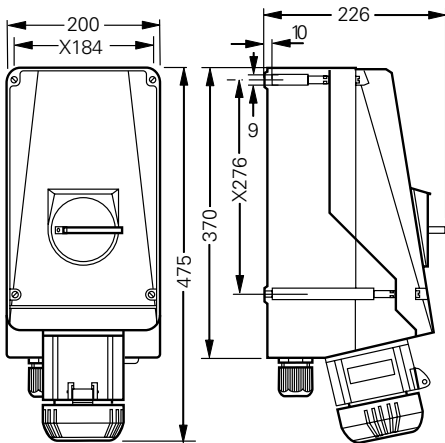

Wall socket 4/5-pole

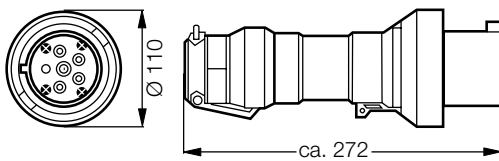

Plug 4/5-pole

X = fixing dimensions

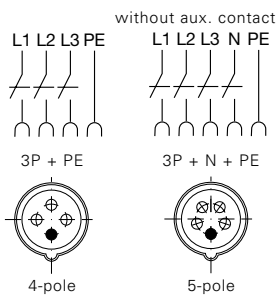

## Ex-plugs and receptacles zone 2: 125 A 3/4/5-pole up to 690 V

1



Wall socket



Plug

### Technical data

#### Ex-plugs and receptacles acc. to IEC 60309-1/2 to 690 V

Marking accd. to 2014/34/EU	⊕ II 3 G Ex de IIC T6
EC-Type Examination Certificate	PTB 99 ATEX 1115
Permissible ambient temperature	-20 °C to + 40 °C <sup>1)</sup>
Rated voltage	690 V
Rated current	125 A
Frequency	up to 400 Hz
Rated making / Rated breaking capacity AC-3 accd. EN 60947-3	$U_e$ 690 V / $I_e$ 125 A
External back up fuse	without therm. protection: 125 A with therm. protection: 160 A gG (rated current 125 A set to)
Protection class	I
Degree of protection accd. to EN 60529	IP66
Enclosure colour	black

#### Wall socket

Cable entry/enclosure drilling	1 x M63 cable gland, 1 x M63 plastic Ex-screw plug or 1 x M50, 1 x M50 plastic Ex-screw plug
Connecting terminals	2 x 4 - 70 mm <sup>2</sup> / with cable lug <sup>2)</sup> 1 x 120 mm <sup>2</sup>
Enclosure material	glass-fibre reinforced polyester

#### Plug

Cable entry	Ø 31 - 58 mm
Connecting terminals	1 x 4 - 35 mm <sup>2</sup> / with pin cable lug <sup>3)</sup> 1 x 50 mm <sup>2</sup>
Enclosure material	Polyamide

<sup>1)</sup> extended temperature range on request

<sup>2)</sup> use supplied cable lugs

<sup>3)</sup> see accessories

Details for used cable glands see pages 2.3.ff

## Ex-plugs and receptacles zone 2: 125 A 3/4/5-pole up to 690 V



Plug



Wall socket

### Ordering details

Voltage	h	Type	Cable entry	Weight approx.	Order No.
<b>Type 125 A 4-pole</b>					
200-250 V		Wall socket	KU	12.3 kg	<b>GHG 519 4409 R0001</b>
		Wall socket	ME	12.5 kg	<b>GHG 519 4409 R3001</b>
		Plug		0.9 kg	<b>GHG 519 7409 R0001</b>
380-415 V		Wall socket	KU	12.3 kg	<b>GHG 519 4406 R0001</b>
		Wall socket	ME	12.5 kg	<b>GHG 519 4406 R3001</b>
		Plug		0.9 kg	<b>GHG 519 7406 R0001</b>
480-500 V		Wall socket	KU	12.3 kg	<b>GHG 519 4407 R0001</b>
		Wall socket	ME	12.5 kg	<b>GHG 519 4407 R3001</b>
		Plug		0.9 kg	<b>GHG 519 7407 R0001</b>
600-690 V		Wall socket	KU	12.3 kg	<b>GHG 519 4405 R0001</b>
		Wall socket	ME	12.5 kg	<b>GHG 519 4405 R3001</b>
		Plug		0.9 kg	<b>GHG 519 7405 R0001</b>
<b>Type 125 A 5-pole</b>					
200-250 V 380-415 V		Wall socket	KU	13.0 kg	<b>GHG 519 4506 R0001</b>
		Wall socket	ME	13.2 kg	<b>GHG 519 4506 R3001</b>
		Plug		1.2 kg	<b>GHG 519 7506 R0001</b>

### Accessories

Type	OU	Order No.
Plug cap 4-pole/5-pole	1	<b>GHG 510 1901 R0007</b>
Set of ring cable lugs 70/120 mm <sup>2</sup> for wall socket (4 + 1 pcs.)	5	<b>GHG 260 1911 R0004</b>
Set of cable lugs 50 mm <sup>2</sup> (5 pcs., for plug)	5	<b>GHG 510 1916 R0002</b>

other voltage ranges and versions, e.g. with aux. contact, on request

KU = 1 x plastic cable glands M40 cable gland, 1 x M40 plastic Ex-screw plug

ME = 2 x metal thread M32 with plastic Ex-screw plug

**Ex-plugs and receptacles zone 2: 125 A 3/4/5-pole up to 690 V**

1



Wall socket



Plug

**Dimension drawing | Wiring diagram**

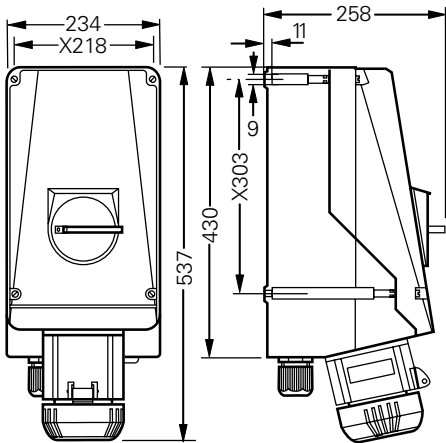

Wall socket 4/5-pole

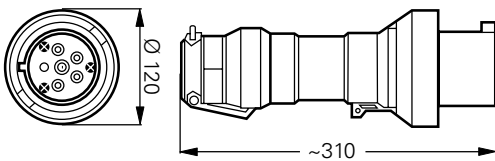

Plug 4/5-pole

X = fixing dimensions

