

EX - PLUGS AND RECEPTACLES

10 A to 125 A
plugs and receptacles plastic version for zone 1, 2, 21 and 22

1 A good connection

Providing electrical energy there, where it is most needed – even in hazardous areas for the Zones 1, 2, 21 and 22.

Non-stationary electrical apparatus have generally high requirements on the energy/power supply. Robust plugs and receptacles as well as a high chemical resistance are at the first glance very important. Electrical reliability is a must not only for all connectivity products.

A high safety standard, a steady hold and faultless contacting even under vibration or the effects of an aggressive atmospheric environment are the basis for a secure and reliable utilisation.

CEAG plugs and receptacles offer more, apart from the proven technology, this product series is defined by its innovative details. For example, the very efficient cable strain relief or the new coding system of the various versions offers different solutions for a secure and problem free utilization in all areas.

Just to round the product off, the user in the normal industrial sector becomes exactly the same product advantages. Robust industrial versions fulfil all requirements appertaining to mechanical and chemical durability. For the stationary repair power supplying in hazardous explosive areas, there is a specially conceived version available that fulfils all the necessary safety requirements. Used in a module sense, individual solutions are no problem at all. The CEAG wall socket for instance can be mounted on to the pre-installed mounting frame without having to use tools – installation without a hot work permit.

Apart from the plugs and receptacles for the European market, we also have plugs and sockets extra for the US market, which are in accordance to all of the necessary standards UL and safety protection systems used there. The available standard range used here, are the 20 A, 30 A, 60 A and 100 A.

International approvals.

- **Nickel-plated contacts**
- **Low insertion force**
- **Safety standard IP66 applies also in the plugged-in state**
- **Full AC-3 switching ability**
- **Self-cleaning lamellar contacts, low transition resistance**
- **All-pole on/off switching**
- **Easy plugging**



Ex-plugs and receptacles 16 A 3/4/5-pole up to 690 V

1



Wall socket



Flange socket



Coupler



Plug

Technical data

Ex-plugs and receptacles acc. to IEC 60309-1/2 16A

Marking accd. to 2014/34/EU	Wall socket, plug, coupler: II 2G / Ex db eb [ia] IIC / IIB+H2 T6 II 2 D Ex IIIC / IIIB T80 Db Flange socket: II 2G Ex db eb IIC / IIB+H2 Gb II 2 D Ex tb IIIC Db
EC-Type Examination Certificate	Wall socket, plug, coupler: BVS 17 ATEX E 053 X Flange socket: BVS 15 ATEX E 101 U
IECEx Certificate of Conformity	Wall socket, plug, coupler: IECEX BVS 17.0045X Flange socket: IECEX BVS 15.0088U
EAC (TR)	1EX D E [IA] IIC/IIB T6 GB X EXTB IIIC T80°C DB X
Permissible ambient temperature	-55 °C to + 55 °C
Rated voltage	up to 415 V, (3-pole) / 690 V, (4-pole) / 690 V, (5-pole) AC
Rated current	16 A
Frequency	up to 400 Hz
Rated making / Rated breaking capacity AC-3 accd. EN 60947-3	Ue 250 V / Ie 16 A (3-pole) Ue 690 V / Ie 16 A (4-pole) Ue 500 V / Ie 16 A (5-pole)
External back-up fuse, max.	without therm. protection: 16 A with therm. protection: 35 A gG (rated current 16 A set to)
Protection class	I
Degree of protection accd. to EN 60529	IP66
Enclosure colour	black

Wall socket

Cable entry	1 x M25 cable gland, 1 x M25 plastic Ex-screw plug or 2 x metal thread M20 with plastic Ex-screw plug
Connecting terminals	2 x 1.5 – 4.0 mm ²
Enclosure material	Glass-fibre reinforced polyester

Plug

Cable entry	Ø 8 – 18 mm (3-pole) / Ø 8 – 21 mm (4-pole) / 12 – 21 mm (5-pole)
Connecting terminals	1 x 1.0 – 4.0 mm ²
Enclosure material	Polyamide

Coupler

Cable entry	Ø 8 – 19 mm (3-pole) / Ø 8 – 21 mm (4-pole) / 12 – 21 mm (5-pole)
Connecting terminals	1 x 1.5 – 4.0 mm ²
Enclosure material	Polyamide

Flange socket

Connecting terminals	2 x 1.5 – 4.0 mm ²
Enclosure material	Polyamide

Plug install protected against higher mechanical risk 4J under -40°C.

Details for used cable glands see pages 2.3.ff

Ex-plugs and receptacles 16 A 3/4/5-pole up to 690 V



Plug



Coupler







Flange socket



Wall socket

Ordering details

Voltage	h	Type	Aux. contact	Cable entry	Weight	Extended temp		Order No.		
						IIB+H2 -55 °C up to +45 °C (16 A)	IIC -20 °C up to +55 °C (10 A)			
Type 16A 3pol										
110-130V	 4 h	Wall socket	-	KU	1.2 kg			X	GHG5114304R0001	
		Wall socket	-	GE	1.2 kg			X	GHG5114304R0002	
		Wall socket	-	GE	1.2 kg		X		GHG5114304R0102	
		Wall socket	-	ME	1.3 kg			X	GHG5114304R3001	
		Wall socket	-	ME	1.3 kg		X		GHG5114304R3101	
		Wall socket	-	GM	1.3 kg			X	GHG5114304R3003	
		Wall socket	-	GM	1.3 kg		X		GHG5114304R3103	
		Flange socket	-		0.4 kg			X	GHG5118304R0001	
		Flange socket	-		0.4 kg		X		GHG5118304R0101	
		Coupler	-		0.7 kg			X	GHG5113304R0001	
		Plug			0.35 kg		X		X	GHG5117304R0001
		Type 16A 3pol								
200-250 V	 6 h	Wall socket	-	KU	1.2 kg			X	GHG5114306R0001	
		Wall socket	-	GE	1.2 kg			X	GHG5114306R0002	
		Wall socket	-	GE	1.2 kg		X		GHG5114306R0102	
		Wall socket	-	ME	1.3 kg			X	GHG5114306R3001	
		Wall socket	-	ME	1.3 kg		X		GHG5114306R3101	
		Wall socket	-	GM	1.3 kg			X	GHG5114306R3003	
		Wall socket	-	GM	1.3 kg		X		GHG5114306R3103	
		Flange socket	-		0.4 kg			X	GHG5118306R0001	
		Flange socket	-		0.4 kg		X		GHG5118306R0101	
		Coupler	-		0.7 kg			X	GHG5113306R0001	
		Plug			0.35 kg		X		X	GHG5117306R0001
		Type 16A 4-pole								
200-250 V	 9 h	Wall socket	-	KU	1.2 kg			X	GHG5114409R0001	
		Wall socket	-	ME	1.3 kg			X	GHG5114409R3001	
		Wall socket	-	ME	1.3 kg		X		GHG5114409R3101	
		Wall socket	-	GM	1.3 kg			X	GHG5114409R3003	
		Wall socket	-	GM	1.3 kg		X		GHG5114409R3103	
		Flange socket	-		1.0 kg			X	GHG5118409R0001	
		Flange socket	-		1.0 kg		X		GHG5118409R0101	
		Coupler	-		1.7 kg			X	GHG5113409R0001	
		Plug			0.35 kg		X		X	GHG5117409R0001
		380-415V	 6 h	Wall socket	-	KU	1.2 kg			X
Wall socket	-			ME	1.3 kg			X	GHG5114406R3001	
Wall socket	-			ME	1.3 kg		X		GHG5114406R3101	
Wall socket	-			GM	1.3 kg			X	GHG5114406R3003	
Wall socket	-			GM	1.3 kg		X		GHG5114406R3103	
Flange socket	-				1.0 kg			X	GHG5118406R0001	
Flange socket	-				1.0 kg		X		GHG5118406R0101	
Coupler	-				1.7 kg			X	GHG5113406R0001	
Plug					0.35 kg		X		X	GHG5117406R0001

Ex-plugs and receptacles 16 A 3/4/5-pole up to 690 V

1



Wall socket



Flange socket





Coupler

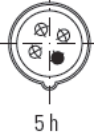

Plug

Ordering details

Voltage	h	Type	Aux. contact	Cable entry	Weight	Temperature ratings		Order No.
						Extended temp IIB+H2 -55 °C up to +45 °C (16 A) IIC-20 °C up to +55 °C (10 A)	Standard temp IIC-20 °C up to +55 °C (16 A)	
Type 16A 4pol								
480-500V		Wall socket	-	KU	1.2 kg		X	GHG5114407R0001
		Wall socket	-	ME	1.3 kg		X	GHG5114407R3001
		Wall socket	-	ME	1.3 kg		X	GHG5114407R3101
		Flange socket	-		1.0 kg		X	GHG5118407R0001
		Flange socket	-		1.0 kg		X	GHG5118407R0101
		Coupler	-		1.7 kg		X	GHG5113407R0001
		Plug			0.35 kg		X	GHG5117407R0001
		600-690V		Wall socket	-	KU	1.4 kg	
Wall socket	-	ME		1.5 kg		X	GHG5114405R3001	
Wall socket	-	ME		1.5 kg		X	GHG5114405R3101	
Flange socket	-			1.0 kg		X	GHG5118405R0001	
Flange socket	-			1.0 kg		X	GHG5118405R0101	
Coupler	-			1.7 kg		X	GHG5113405R0001	
Plug				0.35 kg		X	GHG5117405R0001	
Type 16A 5pol								
200-250V 380-415V		Wall socket	-	KU	1.2 kg		X	GHG5114506R0001
		Wall socket	-	ME	1.3 kg		X	GHG5114506R3001
		Wall socket	-	ME	1.3 kg		X	GHG5114506R3101
		Wall socket	-	GM	1.3 kg		X	GHG5114506R3003
		Wall socket	-	GM	1.3 kg		X	GHG5114506R3103
		Flange socket	-		1.0 kg		X	GHG5118506R0001
		Flange socket	-		1.0 kg		X	GHG5118506R0101
		Coupler	-		1.7 kg		X	GHG5113506R0001
		Plug			0.35 kg		X	GHG5117506R0001

Other voltage ranges and versions available on request

KU = 1 x plastic cable glands M25, 1 x M25 plastic Ex-screw plug

ME = 2 x metal thread M20

GM = 2 x metal thread M20 with screw plug, with external earth bolt M6

GE = 2x plastic thread M20 without gland/screw plug



Wall socket



Plug

Dimension drawing / wiring diagram

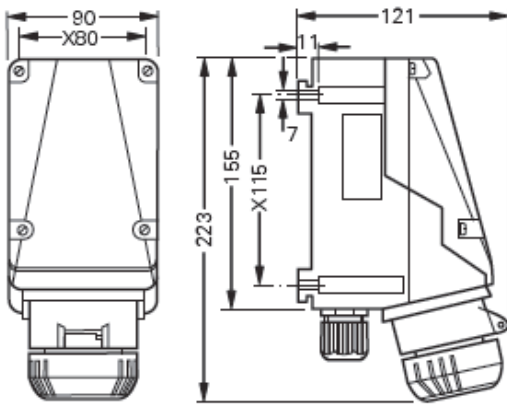

Wall socket 3-pole

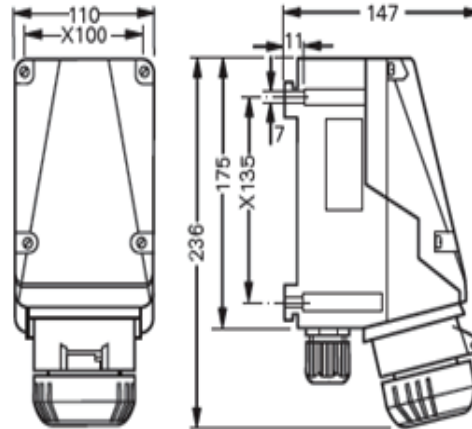

Wall socket 4/5-pole

Wall socket 4/5-pole

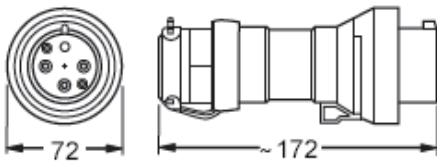

Plug 3-pole

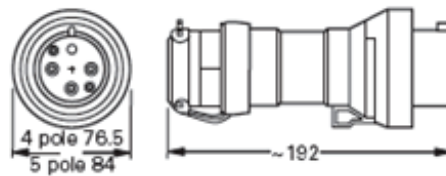

Plug 4/5-pole

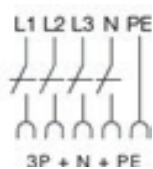
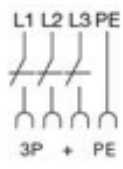
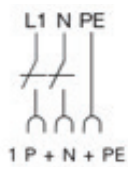

Ex-plugs and receptacles 16 A 3/4/5-pole up to 690 V

1



Flange socket



Coupler

Coupler 3-pole

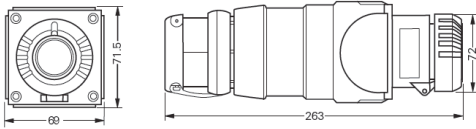

Coupler 4/5-pole

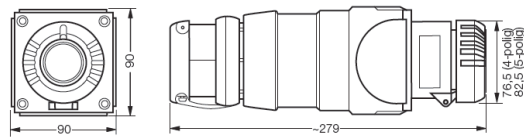

Flange socket 3-pole

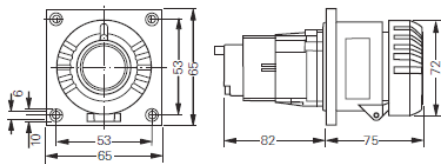

Flange socket 4/5-pole

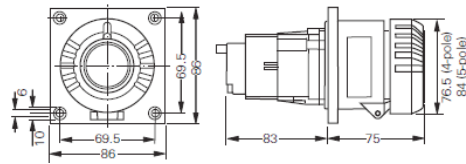

Assembly dimension

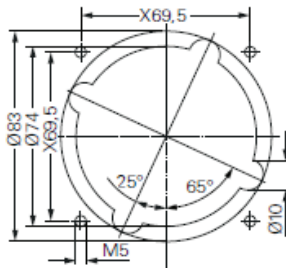
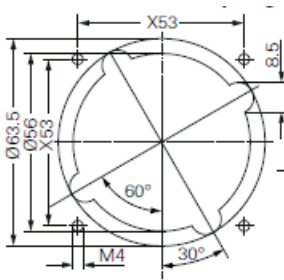

X= fixing dimensions



Angle adapter



Protective canopy



Plug cap



GHG 610 1901 R0126

Accessories

Type	Application	Fixing method	Order No.
------	-------------	---------------	-----------

Mounting plates for wall sockets 16 A

Size 4	for wall mounting	snap on	GHG 610 1953 R0126
Size 4	for trellis mounting	snap on	GHG 610 1953 R0126
Size 4	for pipe clamp	snap on	GHG 610 1953 R0130

Type	Order No.
------	-----------

Plug cap for plugs 16 A

Plug 16 A 3-pole	GHG 510 1901 R0001
Plug 16 A 4-pole	GHG 510 1901 R0002
Plug 16 A 5-pole	GHG 510 1901 R0003

Type	OU	Order No.
------	----	-----------

Accessories for mounting plates

Mounting set for pipes 1" (Ø 27 - 30 mm) for mounting plates with pipe fixing	10	GHG 610 1953 R0020
---	----	--------------------

Please pay attention that only order units (OU) according to the ordering details can be delivered.

Type	Application	Order No.
------	-------------	-----------

Protective canopy for mounting plate

Size 4	for mounting plate size 4, snap on	GHG 610 1955 R0107
--------	------------------------------------	--------------------

Type	Application	Fixing method	Order No.
------	-------------	---------------	-----------

Angle adapter for Wall socket 16 A

16 A 3-pol	Panel mounting	screw	GHG 510 1921 R0001
16/32 A 4/5-pol	Panel mounting	screw	GHG 510 1921 R0002

Dimension drawing

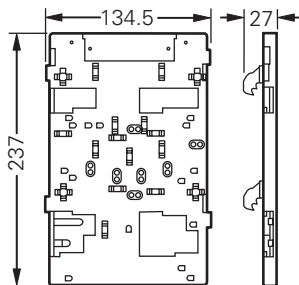

Mounting plate size 4 for wall/trellis mounting

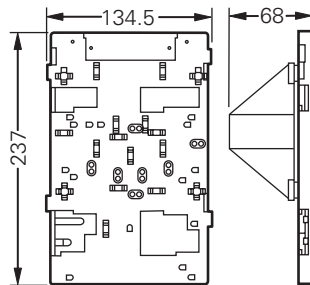

Mounting plate size 4 for pipe clamp

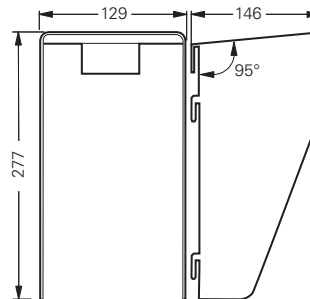

Protective canopy size 4

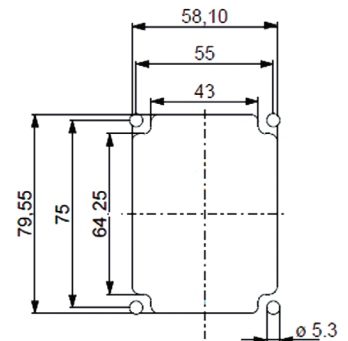

Angle adapter 16A 3-pol.

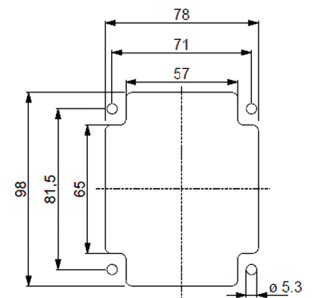

Angle adapter 16/32 A 4/5-pol.

Dimensions in mm

Ex-plugs and receptacles 32 A 4/5-pole up to 690 V



Wall socket



Flange socket



Coupler



Plug

Technical data

Ex-plugs and receptacles acc. to IEC 60309-1/2

Marking accd. to 2014/34/EU	Wall socket, plug, coupler: Flange socket:	II 2G / Ex db eb IIC / IIB T5 Gb II 2 D Ex tb IIIC T80°C Db II 2G Ex db eb IIC / IIB Gb II 2 D Ex tb IIIC Db
EC-Type Examination Certificate	Wall socket, plug, coupler: Flange socket:	BVS 21 ATEX E 001 X BVS 20 ATEX E 090 U
IECEX Certificate of Conformity	Wall socket, plug, coupler: Flange socket:	IECEX BVS 21.0002X IECEX BVS 20.0072 U
Marking accd. to IECEx	Ex db eb IIC/IIB T5 Gb Ex tb IIIC T80°C Db	
EAC (TR)	1EX d e [ia] IIC/IIB T6 Gb X Ex tb IIIC T80°C Db X	
Permissible ambient temperature	Wall socket, plug: Wall socket, plug: Coupler: Flange socket: Flange socket:	IIB -55°C up to +55°C IIC -45°C up to +55°C IIC -25°C up to +55°C IIB -55°C up to +80°C IIC -45°C up to +80°C
Rated voltage	up to 690 V (AC)	
Rated current	32 A	
Frequency	up to 400 Hz	
Rated making / Rated breaking capacity AC-3 accd. EN 60947-3	U_g 690 V / I_g 32 A	
External back up fuse	without thermal protection: 35 A with thermal protection: 50 A gG (rated current 32 A set to)	
Protection class	I	
Degree of protection accd. to EN 60529	IP66	
Enclosure colour	black	

Wall socket

Cable entry/enclosure drilling	1 x M40 cable gland, 1 x M40 plastic Ex-screw plug or 2 x M32 metal thread with 2 plastic Ex-screw plug
Connecting terminals	2 x 4 - 10 mm ²
Enclosure material	glass-fibre reinforced polyester

Plug

Cable entry	Ø 12 - 28 mm
Connecting terminals	2.5 - 6 mm ²
Enclosure material	Polyamide

Coupler

Cable entry	Ø 12 - 28 mm
Connecting terminals	2 x 4 - 10 mm ²
Enclosure material	Polyamide

Flange socket

Connecting terminals	2 x 4 - 10 mm ²
Enclosure material	Polyamide

Details for used cable glands see pages 2.3.ff

Ex-plugs and receptacles 32 A 4/5-pole up to 690 V

1



Plug



Coupler





Flange socket

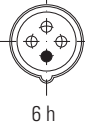

Wall socket

Ordering details

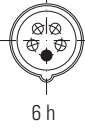
Voltage	h	Type	Aux. contact	Cable entry	Weight approx.	Order No.
Type 32 A 4-pole						
200-250 V		Wall socket	–	KU	2.3 kg	GHG 512 4409 R0001
		Wall socket	–	ME	2.4 kg	GHG 512 4409 R3001
		Wall socket	–	GM	2.3 kg	GHG 512 4409 R3003
		Flange socket			1.0 kg	GHG 512 8409 R0001
		Coupler			1.55 kg	GHG 512 3409 R0001
		Plug			0.55 kg	GHG 512 7409 R0001
		380-415 V		Wall socket	–	KU
Wall socket	–			ME	2.4 kg	GHG 512 4406 R3001
Wall socket	yes			KH	2.3 kg	GHG 512 4406 R0501
Wall socket	–			GM	2.4 kg	GHG 512 4406 R3003
Flange socket					1.0 kg	GHG 512 8406 R0001
Coupler					1.55 kg	GHG 512 3406 R0001
Plug					0.55 kg	GHG 512 7406 R0001
480-500 V		Wall socket	–	KU	2.3 kg	GHG 512 4407 R0001
		Wall socket	–	ME	2.4 kg	GHG 512 4407 R3001
		Wall socket	yes	KH	2.3 kg	GHG 512 4407 R0501
		Flange socket			1.0 kg	GHG 512 8407 R0001
		Coupler			1.55 kg	GHG 512 3407 R0001
		Plug			0.55 kg	GHG 512 7407 R0001
		600-690 V		Wall socket	–	KU
Wall socket	–			ME	2.4 kg	GHG 512 4405 R3001
Wall socket	yes			KH	2.3 kg	GHG 512 4405 R0501
Flange socket					1.0 kg	GHG 512 8405 R0001
Coupler					1.55 kg	GHG 512 3405 R0001
Plug					0.55kg	GHG 512 7405 R0001
Type 32 A 5-pole						
200-250 V 380-415 V		Wall socket	–	KU	2.3 kg	GHG 512 4506 R0001
		Wall socket	–	ME	2.4 kg	GHG 512 4506 R3001
		Wall socket	yes	KH	2.3 kg	GHG 512 4506 R0501
		Wall socket	–	GM	2.4 kg	GHG 512 4506 R3003
		Flange socket			1.0 kg	GHG 512 8506 R0001
		Coupler			1.6 kg	GHG 512 3506 R0001
		Plug			0.6 kg	GHG 512 7506 R0001

Other voltage ranges and versions available on request

KU = 1 x plastic cable glands M40, 1 x M40 plastic Ex-screw plug

KH = 1 x plastic cable glands M40, 1 x plastic cable glands M25, with aux. contact

ME = 2 x metal thread M32 with plastic Ex-screw plug

GM = 2 x metal thread M32 with screw plug, with external earth bolt M6

Ex-plugs and receptacles 32 A 4/5-pole up to 690 V



Wall socket



Flange socket



Coupler



Plug

Dimension drawing | Wiring diagram

Dimensions in mm

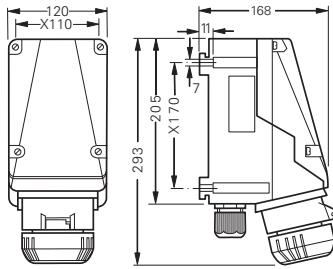

Wall socket 4-pole

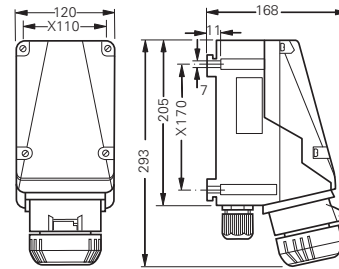

Wall socket 5-pole

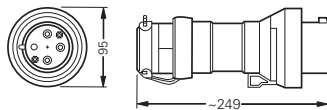

Plug 4-pole

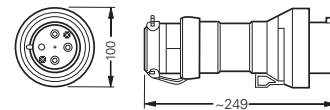

Plug 5-pole

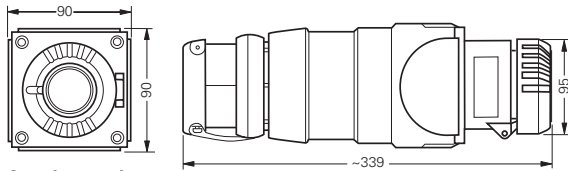

Coupler 4-pole

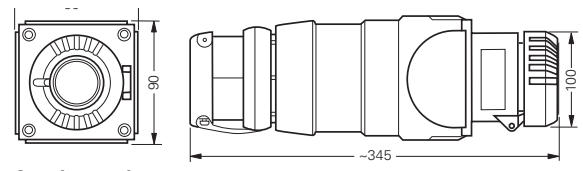

Coupler 5-pole

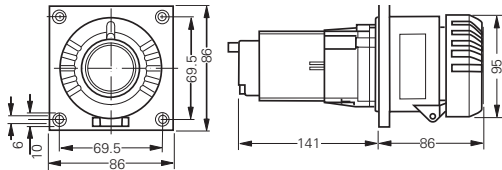

Flange socket 4-pole

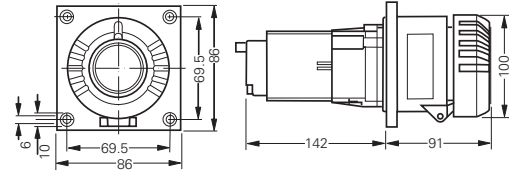

Flange socket 5-pole

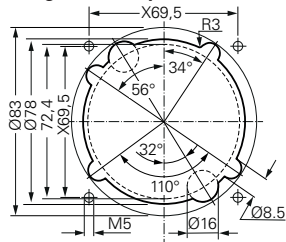

Assembly dimensions flange socket

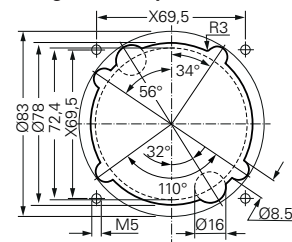

Assembly dimensions flange socket X = fixing dimensions

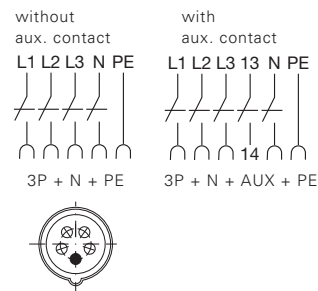
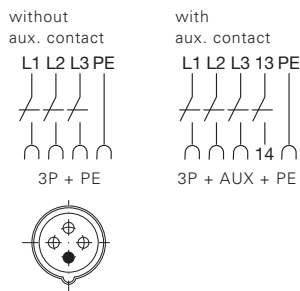



Angle adapter



Protective canopy



Plug cap

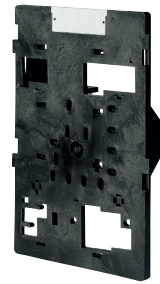

GHG 610 1901 R0128

Accessories

Type	Application	Fixing method	Order No.
Mounting plates for wall sockets 32 A			
Size 5	for wall mounting	snap on	GHG 610 1953 R0128
Size 5	for trellis mounting	snap on	GHG 610 1953 R0128
Size 5	for pipe clamp	snap on	GHG 610 1953 R0132

Type	Order No.
Plug cap for plugs 32 A	
Plug 32 A 4-pole	GHG 510 1901 R0004
Plug 32 A 5-pole	GHG 510 1901 R0005

Type	OU	Order No.
Accessories for mounting plates		
Mounting set for pipes 1" (Ø 27 - 30 mm) for mounting plates with pipe fixing	10	GHG 610 1953 R0020

Please pay attention that only order units (OU) according to the ordering details can be delivered.

Type	Application	Order No.
Protective canopy for mounting plate		
Size 5	for mounting plate size 5, snap on	GHG 610 1955 R0108

Type	Application	Fixing method	Order No..
Angle adapter for Wall socket 32 A			
32 A 4/5-pol	Panel mounting	screw	GHG 510 1921 R0002

Dimension drawing

Dimensions in mm

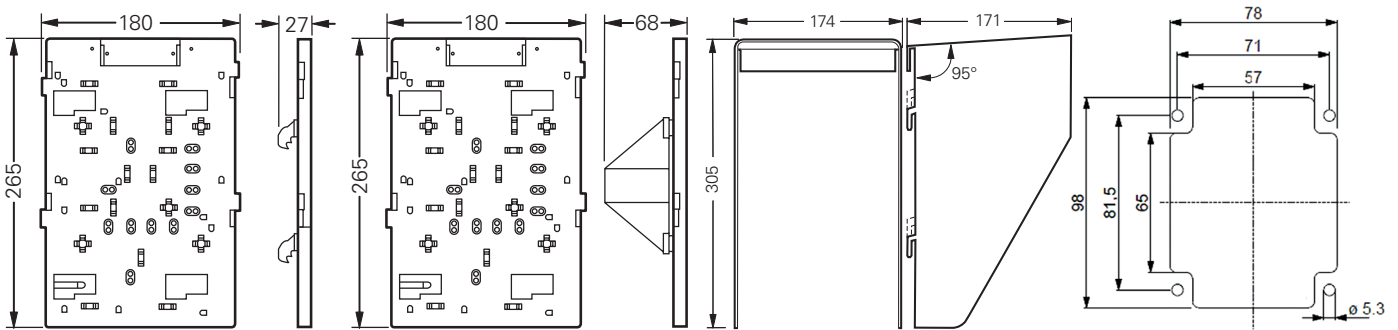

Mounting plate size 5 for wall/trellis mounting

Mounting plate size 5 for pipe mounting

Protective canopy size 5

Angle adapter 16/32 A 4/5-pol.

Ex-plugs and receptacles for extended temperatures: 63 A 4/5-pole up to 690 V



Plug



Wall socket

Technical data

Ex-plugs and receptacles acc. to IEC 60309-1/2 up to 690 V

Marking accd. to 2014/34/EU	Ⓢ II 2G Ex db eb IIC/IIB T5 Gb Ⓢ II 2D Ex tb IIIC T80°C Db
Marking accd. to 2014/34/EU	Ex db eb IIC/IIB T5 Gb Ex tb IIIC T80°C Db
EC-Type Examination Certificate	BVS 17 ATEX E 073 X
IECEx Certificate of Conformity	IECEx BVS 17.0062X
Permissible ambient temperature	-55 °C to + 55 °C ³⁾
Rated voltage	690 V AC (4-pole) / 500V AC (5-pole)
Rated current	63 A
Frequency	up to 400 Hz
Rated making / Rated breaking capacity AC-3 accd. EN 60947-3	U_g 690 V / I_g 63 A
External back up fuse	without therm. protection: 63 A with therm. protection: 80 A gG (rated current 63 A set to)
Protection class	I
Degree of protection accd. to EN 60529	IP66
Enclosure colour	black

Wall socket

Cable entry/enclosure drilling	1 x M50 cable gland, 1 x M50 plastic Ex-screw plug or 2 x M40 metal thread with plastic Ex-screw plug
Connecting terminals	2 x 4 - 25 mm ² / with cable lug ¹⁾ 1 x 35 mm ²
Enclosure material	glass-fibre reinforced polyester

Plug

Cable gland	Ø 19 - 34 mm
Connecting terminals	1 x 4 - 16 mm ² / 1 x 25 mm ² with pin cable lug ²⁾
Enclosure material	Polyamide

¹⁾ use supplied cable lugs

²⁾ see accessories

³⁾ Wall socket install protected against higher mechanical risk 4J under -40°C.

Details for used cable glands see pages 2.3.ff

Ex-plugs and receptacles for extended temperatures: 63 A 4/5-pole up to 690 V



Wall socket



Plug

Ordering details

Voltage	h	Aux. contact	Cable entry	Type	IIB / IIC low temp -55 °C up to +40/+55 °C	IIC high temp -20 °C up to +55 °C	Weight approx.	Order No.	
Type 63 A 4-pole									
200-250 V		-	KU	Wall socket		X	8.1 kg	GHG514 4409 R0001	
		-	ME	Wall socket			X	8.2 kg	GHG514 4409 R3001
		-	ME	Wall socket		X		8.2 kg	GHG514 4409 R3101
				Plug		X	X	0.9 kg	GHG514 7409 R0001
380-415 V		-	KU	Wall socket		X	8.1 kg	GHG514 4406 R0001	
		-	ME	Wall socket			X	8.2 kg	GHG514 4406 R3001
		-	ME	Wall socket		X		8.2 kg	GHG514 4406 R3101
		-	GM	Wall socket			X	8.2 kg	GHG514 4406 R3003
		-	GM	Wall socket		X		8.2 kg	GHG514 4406 R3103
				Plug		X	X	0.9 kg	GHG514 7406 R0001
480-500 V		-	KU	Wall socket		X	8.1 kg	GHG514 4407 R0001	
		-	ME	Wall socket			X	8.2 kg	GHG514 4407 R3001
		-	ME	Wall socket		X		8.2 kg	GHG514 4407 R3101
		-	GM	Wall socket			X	8.2 kg	GHG514 4407 R3003
		-	GM	Wall socket		X		8.2 kg	GHG514 4407 R3103
				Plug		X	X	0.9 kg	GHG514 7407 R0001
600-690 V		-	KU	Wall socket		X	8.1 kg	GHG514 4405 R0001	
		-	ME	Wall socket			X	8.2 kg	GHG514 4405 R3002
		-	ME	Wall socket		X		8.2 kg	GHG514 4405 R3102
				Plug		X	X	0.9 kg	GHG514 7405 R0001
Type 63 A 5-pole									
200-250 V		-	KU	Wall socket		X	8.1 kg	GHG514 4506 R0001	
380-415 V		-	ME	Wall socket			X	8.2 kg	GHG514 4506 R3001
		-	ME	Wall socket		X		8.2 kg	GHG514 4506 R3101
		-	GM	Wall socket			X	8.2 kg	GHG514 4506 R3006
		-	GM	Wall socket		X		8.2 kg	GHG514 4506 R3106
				Plug		X	X	0.9 kg	GHG514 7506 R0001

other voltage ranges and versions, e.g. with aux. contact, on request

KU = 1 x plastic cable glands M40 cable gland, 1 x M40 plastic Ex-screw plug

ME = 2 x metal thread M32 with plastic Ex-screw plug

Ex-plugs and receptacles for extended temperatures: 63 A 4/5-pole up to 690 V



Plug



Wall socket

Dimension drawing / wiring diagram

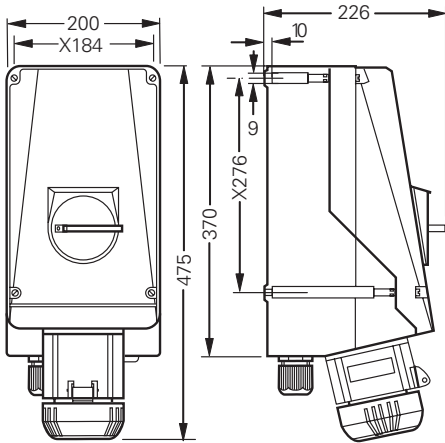

Wall socket 4/5-pole

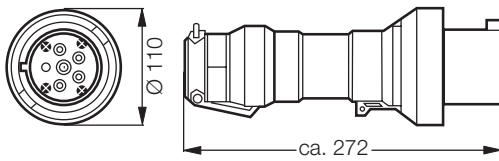

Plug 4/5-pole

X = fixing dimensions

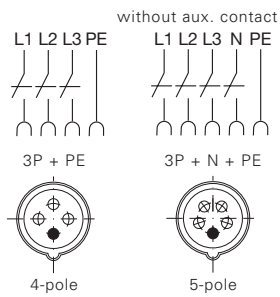



Plug



Wall socket

1

Technical data

Ex-plugs and receptacles acc. to IEC 60309-1/2

Marking accd. to 2014/34/EU	Ⓜ II 2 G Ex de IIC T6 / Ⓜ II 2 D Ex tD A21 IP66 T80 °C
EC-Type Examination Certificate	PTB 01 ATEX 1069
IECEX Certificate of Conformity	IECEX BK1 04.0005
Marking accd. to IECEx	Ex ed IIC T6
Permissible ambient temperature	-20 °C to + 40 °C ¹⁾
Rated voltage	690 V
Rated current	125 A
Frequency	up to 400 Hz
Rated making / Rated breaking capacity AC-3 accd. EN 60947-3	Ue 690 V / Ie 125 A
External back up fuse	without therm. protection: 125 A with therm. protection: 160 A gG (rated current 125 A set to)
Protection class	I
Degree of protection accd. to EN 60529	IP66
Enclosure colour	black

Wall socket

Cable entry/enclosure drilling	1 x M63 cable gland, 1 x M63 plastic Ex-screw plug or 2 x M50 metal thread with 2 plastic Ex-screw plug
Connecting terminals	2 x 4 - 70 mm ² / with ring cable lug ²⁾ 1 x 120 mm ²
Enclosure material	glass-fibre reinforced polyester

Plug

Cable entry	Ø 31 - 55 mm
Connecting terminals	1 x 4 - 35 mm ² / with pin cable lug ³⁾ 1 x 50 mm ²
Enclosure material	Polyamide

¹⁾ extended temperature range on request

²⁾ use supplied cable lugs

³⁾ see accessories

Details for used cable glands see pages 2.3.ff

Ex-plugs and receptacles 125 A 4/5-pole up to 690 V

1



Wall socket







Plug



Plug cap

Ordering details

Voltage	h	Type	Aux. contact	Cable entry	Weight approx.	Order No.
Type 125 A 4-pole						
200-250 V		Wall socket	–	KU	12.3 kg	GHG 515 4409 R0001
		Wall socket	–	ME	12.5 kg	GHG 515 4409 R3001
		Wall socket	yes	KH	12.5 kg	GHG 515 4409 R0501
		Plug			1.5 kg	GHG 515 7409 R0001
380-415 V		Wall socket	–	KU	12.3 kg	GHG 515 4406 R0001
		Wall socket	–	ME	12.5 kg	GHG 515 4406 R3001
		Wall socket	yes	KH	12.5 kg	GHG 515 4406 R0501
		Wall socket	–	GM	8.2 kg	GHG 515 4406 R3003
		Plug			1.5 kg	GHG 515 7406 R0001
480-500 V		Wall socket	–	KU	12.3 kg	GHG 515 4407 R0001
		Wall socket	–	ME	12.5 kg	GHG 515 4407 R3001
		Wall socket	yes	KH	12.5 kg	GHG 515 4407 R0501
		Wall socket	–	GM	8.2 kg	GHG 515 4407 R3002
		Plug			1.5 kg	GHG 515 7407 R0001
600-690 V		Wall socket	–	KU	12.3 kg	GHG 515 4405 R0001
		Wall socket	–	ME	12.5 kg	GHG 515 4405 R3001
		Wall socket	yes	KH	12.5 kg	GHG 515 4405 R0501
		Wall socket	–	GM	8.2 kg	GHG 515 4405 R3002
		Plug			1.5 kg	GHG 515 7405 R0001
Type 125 A 5-pole						
200-250 V		Wall socket	–	KU	13.0 kg	GHG 515 4506 R0001
380-415 V		Wall socket	–	ME	13.2 kg	GHG 515 4506 R3001
		Wall socket	yes	KH	13.2 kg	GHG 515 4506 R0501
		Wall socket	–	GM	8.2 kg	GHG 515 4506 R3005
		Plug			1.2 kg	GHG 515 7506 R0001

Accessories

Type	OU	Order No.
Plug cap 4-pole/5-pole	1	GHG 510 1901 R0007
Set of ring cable lug 70/120 mm ² for wall socket (je 4 + 1 pcs.)	1	GHG 260 1911 R0004
Set of cable lugs 50 mm ² (5 pcs., for plug)	5	GHG 510 1916 R0002

Other voltage ranges and versions available on request

KU = 1 x plastic cable glands M63, 1 x M40 plastic Ex-screw plug

KH = 1 x plastic cable glands M63, 1 x plastic cable glands M25, with aux. contact

ME = 2 x metal thread M50 with plastic Ex-screw plug

GM = 2 x metal thread M50 with screw plug, with external earth bolt M8



Plug



Wall socket

1

Dimension drawing | Wiring diagram

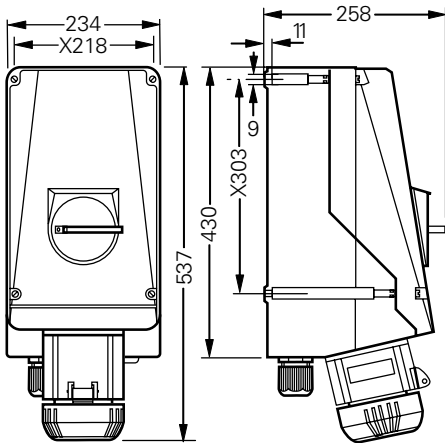

Wall socket 4/5-pole

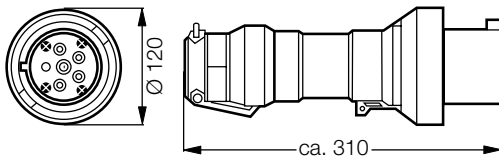

Plug 4/5-pole

X = fixing dimensions

without aux. contact

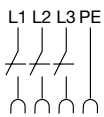

3P + PE



with aux. contact

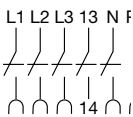

3P + AUX + PE

without aux. contact

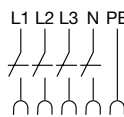

3P + N + PE



with aux. contact

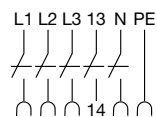

3P + N + AUX + PE