



CXH1 - 102PL



CXH2 - 102PL



CXH3 - 102PL



CXH4 - 102PL



CXH6 - 102PL

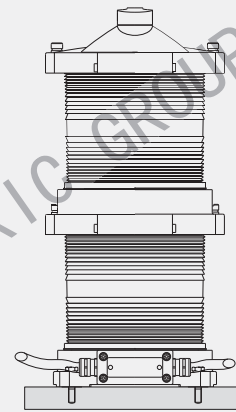
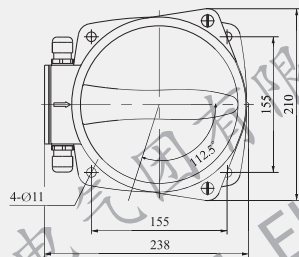
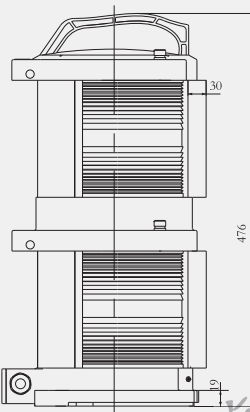

安装示意图 Installation Diagram

适用范围 The Scope of Application

适用于50米或50米以上各类船舶作夜间航行灯光信号。
Applied to the ships with the length of 50m or above as lamp signal liaison when night navigation.

名称 Name	右舷灯 Starboard Light	左舷灯 Port Light	桅灯 Masthead Light	艉灯 Stern Light	环照灯 All-round Light
型号 Type	CXH1-102PL	CXH2-102PL	CXH3-102PL	CXH4-102PL	CXH6-102PL
额定电压 Rated Voltage	AC100~240V 50/60Hz、DC24V				
功率 Power	2*6W	2*6W	2*8W	2*6W	2*6W
光源 Illuminant	LED				
颜色 Color	绿 Green	红 Red	白 White	白/黄 White/Yellow	红/绿/白 Red/Green/White
水平光弧 Horizontal Arc	112.5°	112.5°	225°	135°	360°
垂直光弧 Vertical Arc	±5°				
可见距离 Visible Distance	3n.m	3n.m	6n.m	3n.m	3n.m
防护等级 Protection Class	IP66				
电缆外径 Cable Outside Diameter	Ø10~Ø14				
安装方式 Installation Method	座式 Seat-mounted Type				
环境温度 Ambient Temperature	-30℃ ~ +55℃				
灯体材质 Lamp Body Material	工程塑料PA+GF High-strength Engineering Plastic PA+GF				
灯罩材质 Lamp Shade Material	工程塑料PC Engineering Plastic PC				
灯罩颜色 Lamp Shade Color	透明 Transparent				
重量 Weight	6.2kg	6.2kg	6.2kg	6.2kg	6kg