

ELXc – ECO EffectLine Warm Start for TC Lamps

Electronic built-in ballasts

Casing: PC, white

Mains voltage: 198–264 V

Push-in terminals: 0.5–1.5 mm²

RFI-suppressed

For luminaires of protection class I

Degree of protection: IP20

For lighting systems with
high switching frequency (> 5/day)

EOL shut down approved acc. to EN 61347 Test 1



ECO EffectLine

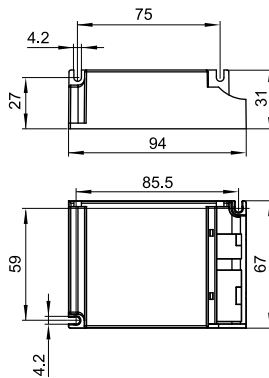

Lamp				Electronic ballast								System	
Output	Type	Base	Power consumption	Type	Ref. No.	Voltage AC	Energy efficiency	Power factor	Ambient temperature	Casing temperature	Output	Luminous factor	
W			W			50, 60 Hz			t _a [°C]	t _c [°C]	W	%	
For TC lamps													
18	TC-DEL/-TEL	G24q-2/GX24q-2	1 x 16.5	ELXc 118.879	183134	220-240	A3	> 0,95	-10 to 50	max. 70	19.5	100	
2 x 18	TC-DEL/-TEL	G24q-2/GX24q-2	2 x 16.5	ELXc 218.881	183136	220-240	A2	> 0,95	-15 to 50	max. 75	38.0	100	
26	TC-DEL/-TEL	G24q-3/GX24q-3	1 x 24.0	ELXc 126.880	183135	220-240	A3	> 0,95	-10 to 50	max. 75	28.0	100	
2 x 26	TC-DEL/-TEL	G24q-3/GX24q-3	2 x 24.0	ELXc 226.882	183137	220-240	A2	> 0,95	-15 to 50	max. 80	53.5	100	

ELXs – Warm Start for Compact Fluorescent Lamps

Electronic built-in ballasts

Casing: heat-resistant polyamide

Power factor: approx. 0.6

(depending on the lamp output)

DC voltage operation: 198-264 V

Push-in terminals with push-button: 0.5-1.5 mm²

RFI-suppressed

For luminaires of protection class I and II

Degree of protection: IP20

Fixing slots for screws M4

For lighting systems with high switching frequency (> 5/day)

EOL shut down approved

acc. to EN 61347 Test 2

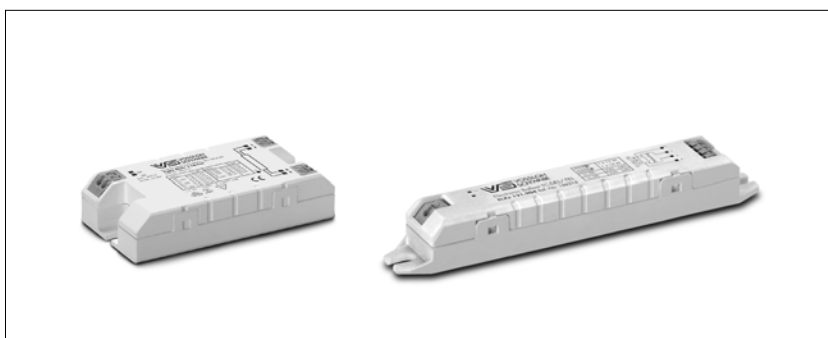

K20

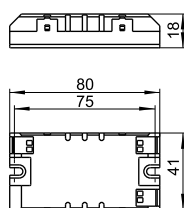

K21

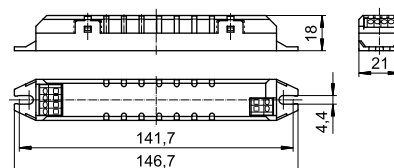

Lamp				Electronic ballast							System	
Output W	Type	Base	Power consumption W	Type	Ref. No.	Voltage AC 50, 60 Hz V±10%	Energy efficiency	Ambient temperature t _a (°C)	Casing temperature t _c (°C)	Casing	Output W	
5	TC-SEL	2G7	1 x 5.0	ELXs 116.900	188661	220-240	A3	-15 to 55	max. 75	K20	6.1	
				ELXs 116.903	188662	220-240	A3	-15 to 55	max. 75	K21	6.1	
7	TC-SEL	2G7	1 x 6.4	ELXs 116.900	188661	220-240	A2	-15 to 55	max. 75	K20	7.5	
				ELXs 116.903	188662	220-240	A2	-15 to 55	max. 75	K21	7.5	
9	TC-SEL	2G7	1 x 8.0	ELXs 116.900	188661	220-240	A2	-15 to 55	max. 75	K20	8.8	
				ELXs 116.903	188662	220-240	A2	-15 to 55	max. 75	K21	8.8	
10	TC-DEL	G24q-1	1 x 9.3	ELXs 116.900	188661	220-240	A2	-15 to 55	max. 75	K20	10.2	
	TC-DD	GR10q	1 x 9.3	ELXs 116.900	188661	220-240	A2	-15 to 55	max. 75	K20	10.3	
	TC-DEL	G24q-1	1 x 9.3	ELXs 116.903	188662	220-240	A2	-15 to 55	max. 75	K21	10.2	
	TC-DD	GR10q	1 x 9.3	ELXs 116.903	188662	220-240	A2	-15 to 55	max. 75	K21	10.3	
11	TC-SEL	2G7	1 x 10.8	ELXs 116.900	188661	220-240	A2	-15 to 55	max. 75	K20	11.8	
				ELXs 116.903	188662	220-240	A2	-15 to 55	max. 75	K21	11.8	
13	TC-DEL/-TEL	G24q-1/GX24q-1	1 x 12.5	ELXs 121.901	188663	220-240	A2	-15 to 55	max. 80	K20	15.5	
				ELXs 121.904	188664	220-240	A2	-15 to 55	max. 80	K21	15.5	
16	TC-DD	GR10q	1 x 13.2	ELXs 116.900	188661	220-240	A3	-15 to 55	max. 75	K20	15.1	
				ELXs 116.903	188662	220-240	A3	-15 to 55	max. 75	K21	15.1	
18	TC-DEL/-TEL	G24q-2/GX24q-2	1 x 15.3	ELXs 121.901	188663	220-240	A2	-15 to 55	max. 80	K20	16.9	
				ELXs 121.904	188664	220-240	A2	-15 to 55	max. 80	K21	16.9	
	TC-F/-L	2G10/2G11	1 x 16.0	ELXs 124.902	188665	220-240	A2	-15 to 55	max. 85	K20	17.9	
				ELXs 124.905	188666	220-240	A2	-15 to 55	max. 85	K21	17.9	
22	T-R5	2GX13	1 x 19.1	ELXs 124.902	188665	220-240	A2	-15 to 55	max. 85	K20	21.2	
				ELXs 124.905	188666	220-240	A2	-15 to 55	max. 85	K21	21.2	
24	TC-F/-L	2G10/2G11	1 x 20.0	ELXs 124.902	188665	220-240	A2	-15 to 55	max. 85	K20	21.4	
				ELXs 124.905	188666	220-240	A2	-15 to 55	max. 85	K21	21.4	
				1 x 20.8	ELXs 126.906	188667	220-240	A2	-15 to 55	max. 85	K20	22.9
					ELXs 126.907	188668	220-240	A2	-15 to 55	max. 85	K21	22.9
26	TC-DEL/-TEL	G24q-3/GX24q-3	1 x 21.5	ELXs 126.906	188667	220-240	A2	-15 to 55	max. 85	K20	23.4	
				ELXs 126.907	188668	220-240	A2	-15 to 55	max. 85	K21	23.4	